



ADMISSION CHECKLIST



10UT

Patient Name: \_\_\_\_\_ Date: \_\_\_\_\_

Physician Office: \_\_\_\_\_

In order to expedite our patient(s) admission process, please use this checklist as a guideline for the admission process. Check-off each item as it is completed.

- Physician orders (include diagnosis, status, condition and allergies)
- Copy of office labs and / or x-ray reports
- Copy of physical findings / exam
- Admission folder given to patient
- Insurance / Medicaid precert number

Thank you for your cooperation and assistance. Please sign your name below, including your office phone number, in case Registration or Bed Placement needs to contact you.

Signature: \_\_\_\_\_ Office Phone #: \_\_\_\_\_

# DIRECTIONS TO CRMC ADMISSION OFFICE AND SERVICES

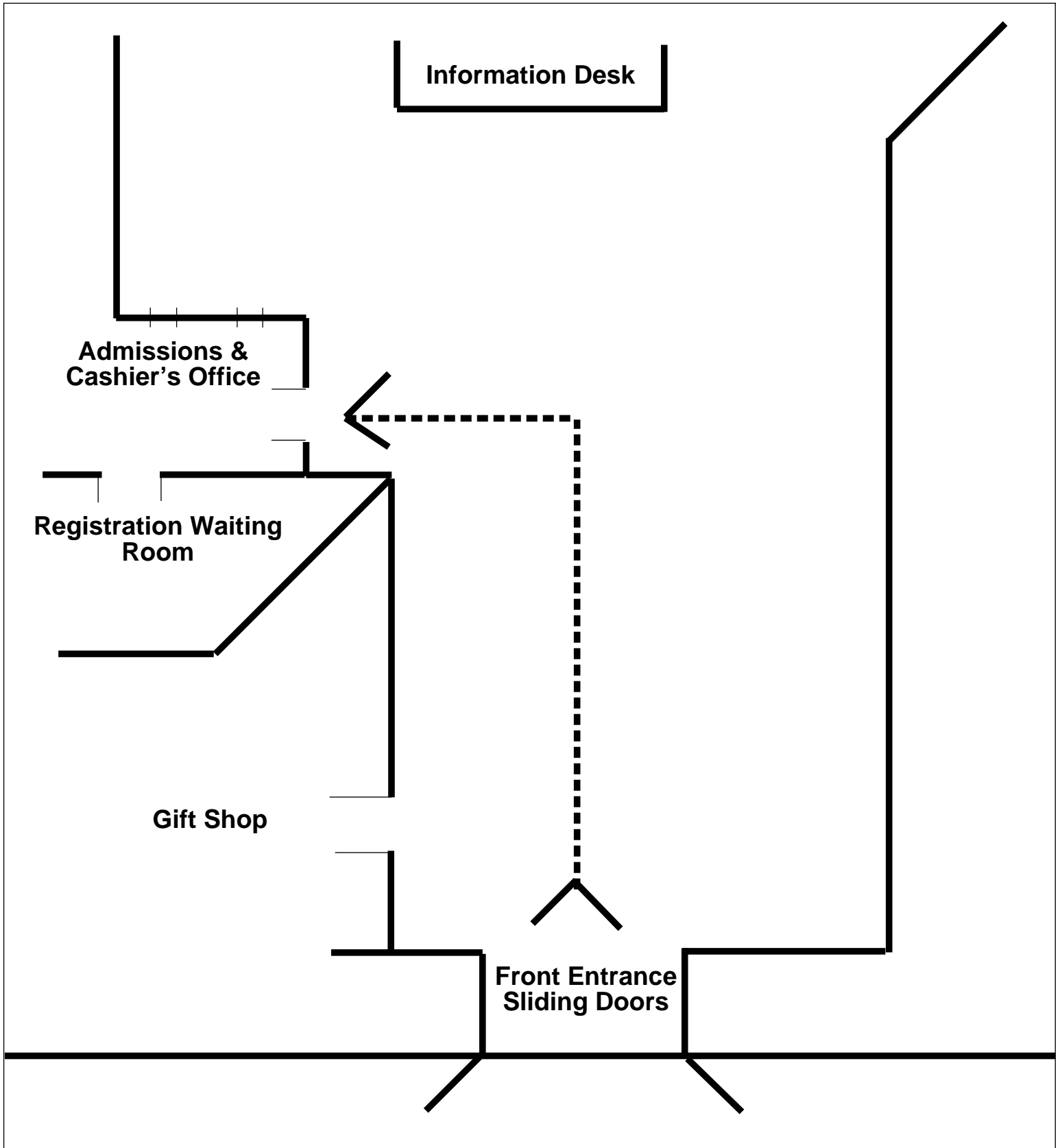



# DIRECTIONS TO CRMC ADMISSION OFFICE AND SERVICES

Please visit our website at  
[www.coffeeregional.org](http://www.coffeeregional.org)  
on the "Contact Us" page for a  
list of our services with phone  
numbers and addresses

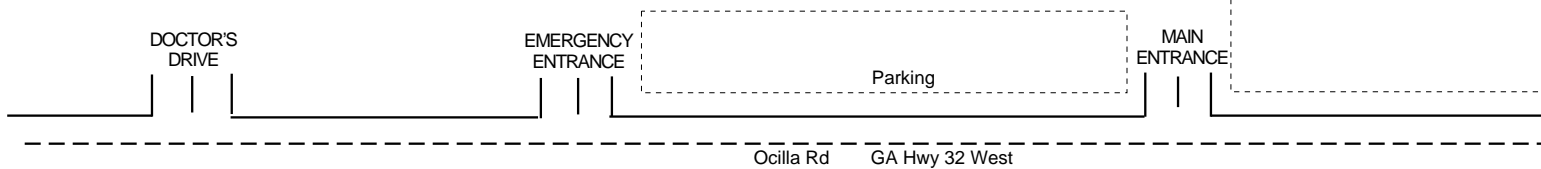
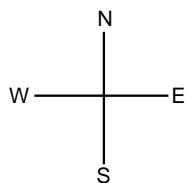
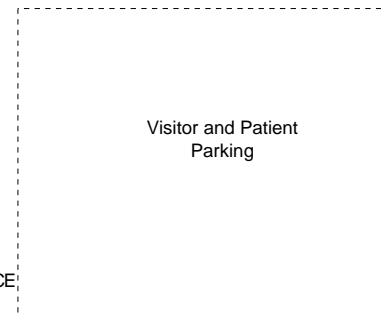
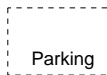
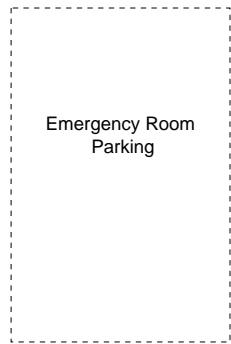
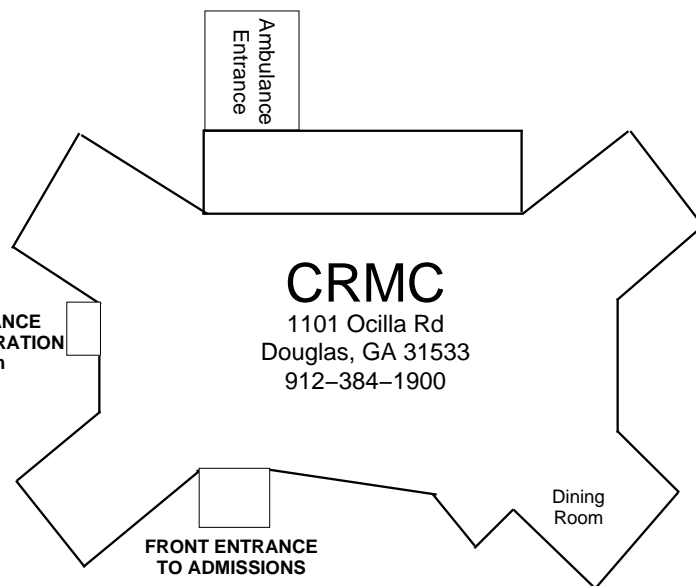
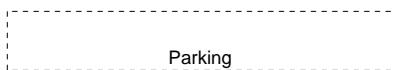
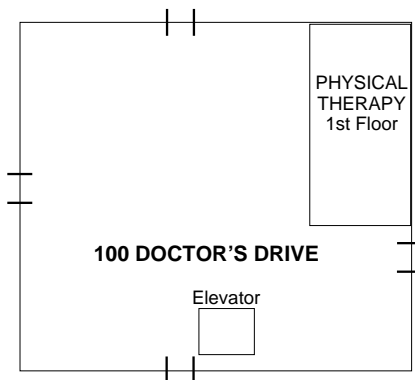
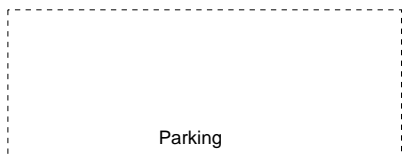
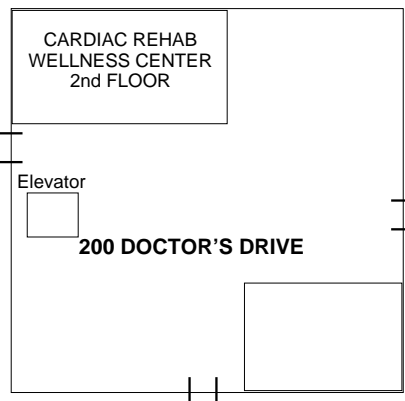



Main Campus  
1101 Ocilla Road  
Douglas, GA 31533  
912.384.1900  
912.389.2112 (fax)  
Email

Human Resources  
800.555.4444  
912.384.8283 (fax)  
Email

Volunteer & Foundation  
Keith Newell  
Director  
912.383.6910  
912.389.2112 (fax)  
Email

CRMC Advanced Wound Care &  
Hyperbarics  
304 Westside Dr  
Douglas, GA 31533  
912.720.7002

CRMC Wellness Center  
200 Doctors Dr.,  
Suite R  
Douglas, GA 31533  
912.383.6988  
912.389.2164 (fax)

CRH Cardiology Group  
1305 Ocilla Road  
Douglas, GA 31533  
912.384.0600  
912.384.0601 (fax)

CRH Family Medicine Group  
100 Doctors Dr,  
Suites F & G  
Douglas, GA 31533  
912.384.9898  
912.384.6187 (fax)

CRH Industrial Medicine  
205 Shirley Avenue  
Douglas, GA 31533  
912.260.5400  
912.260.5177 (fax)

CRH Internal Medicine  
200 Doctors Dr., Suite K  
Douglas, GA 31533  
912.384.4024  
912.384.4040 (fax)

CRH Neurology Group  
200 Doctors Dr., Suite L  
Douglas, GA 31533  
912.383.6360  
912.383.6380 (fax)

Orthopedic Surgeons of GA  
100 Doctors Dr., Suite I  
Douglas, GA 31533  
912.383.6575  
912.383.6476 (fax)

CRH Pediatric Group  
200 Doctors Dr., Suite P  
Douglas, GA 31533  
912.384.9460  
912.393.1239 (fax)

CRH School Based Health Clinic  
Coffee Middle School  
901 Georgia 206, Douglas, GA  
31533  
912.389.6885  
912.393.1015 (fax)

CRH Surgical Group  
100 Doctors Dr., Suite C  
Douglas, GA 31533  
912.384.5832  
912.383.8279 (fax)

CRH Urology Group  
200 Doctors Dr., Suite Q  
Douglas, GA 31533  
912.384.4030  
912.384.4039 (fax)

CRH Women's Center  
2010 Ocilla Road  
Douglas, GA 31533  
912.384.2500  
912.383.6788 (fax)

CRH Urology Clinic  
2007 Ocilla Hwy  
Douglas, GA 31533  
912.384.0162

CRH Oncology Group  
903 B W. Ward St  
Douglas, GA 31533  
912.384.4111

CRH Medical Specialty Group  
200 Doctors Dr, Suite S  
Douglas, GA 31533  
912.292.0658

CRMC Walk-In Clinic  
205 Shirley Avenue  
Douglas, GA 31533  
912.383.6966  
7 Days a Week – 7:30am–7:30pm

CRMC Pharmacy  
1101 Ocilla Road  
Douglas, GA 31533  
912.383.5666

Medical Staff Services Affiliation  
Requests  
1101 Ocilla Hwy  
Attn: Medical Staff Services  
Douglas, GA 31533  
912.383.5623  
912.389.2105 (fax)

CRMC Patient Financial Services  
196 Westside Drive  
Douglas, GA 31533  
912.383.5614  
8am–5pm Monday–Friday

Health Info Services/Medical  
Records  
1101 Ocilla Road  
Douglas, GA 31533  
912.384.1900 Ext–4552

CRMC Central Scheduling  
1101 Ocilla Road  
Douglas, GA 31533  
912.384.1900 Ext–6918  
912.389.2165 (fax)